

DAVIS SEATING



Seating Design, Manufacturing & Installation

For more than thirty years, our friendly team has helped clients across the United States and now in Puerto Rico with AE Nova Distributing, Inc., abroad to successfully design and install seating that meets their distinct needs. Working with venues ranging from opera houses to stockyards, you can count on Davis Furniture Company to help you get the right seating at an affordable price.



Opera Chair

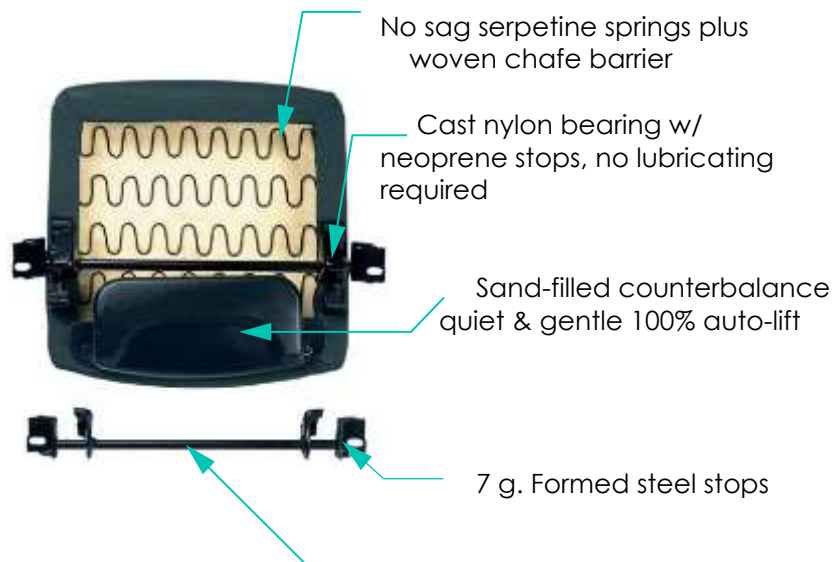
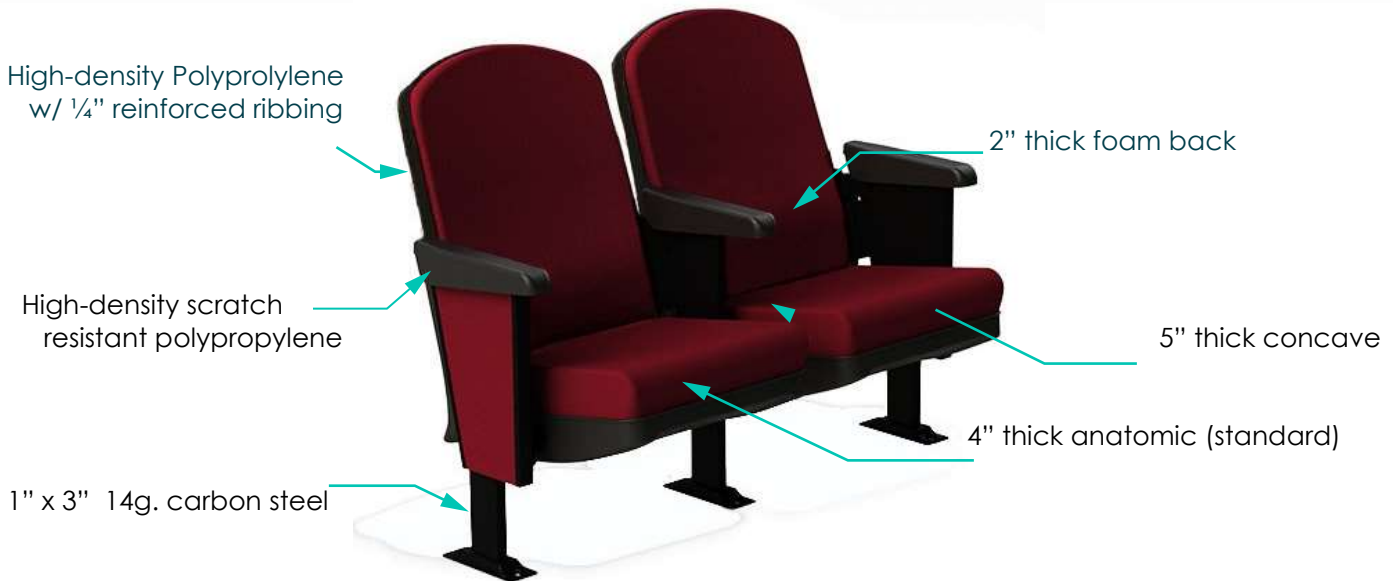

Solid 5/8" steel cross shaft

ARMS OPTIONS



Polypropylene armrest with frontmounted cup holder. Adds an approximate 4" to depth of chair.

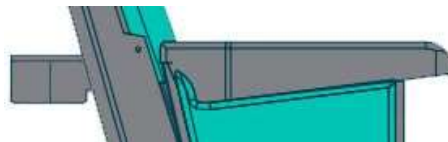

Rear-mounted cup holder



Flat



Scrolled



Longitudinal

Solid wood armrests. Choice of wood and stain. Length within typical depth of chair.

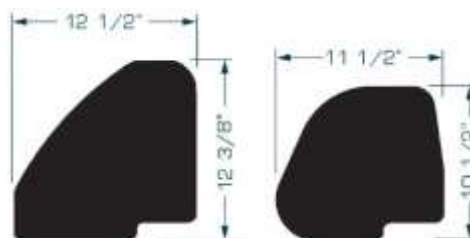



BACK OPTIONS

Each of our backs use 50/55 kg/m³ foam affixed to an injection molded, high-density polypropylene inner back with ¼" reinforced ribbing. Polypropylene is textured to resist scratching and scuffing. Additional outer back options include laminate or wood veneer.



Flat

2" thick foam



Lumbar

2" thick
Foam
increasing
to 3" at
lumbar
area



Vertical Pleats

2" thick foam
increasing to
3" at lumbar area
with decorative
vertical pleating

Button pleating also
available

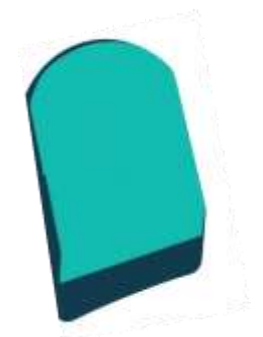

Opera

2" thick foam
with soft
curved top
of back.

ROW ENDS

Create a unique space by adding custom row ends to your installation. PLAM to cast aluminum to polypropylene, row ends can significantly change the entire feel of the room. Below are common ends provided by DFC. Looking for something you don't see, let us know and...!



3/4" Soft rectangle



3/4" Tapered Radius



3/4" Tapered



3/4" Radius



Full-Length Panel

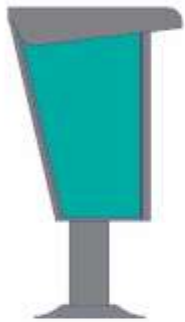

Convention T

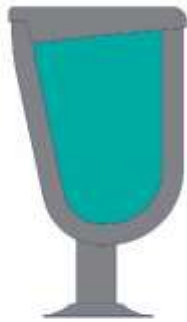

Oval 300



Compact

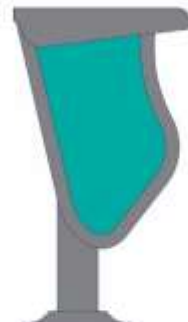

Roma S



HRL (Polypropylene)



Lifting Arm/Cantiliver

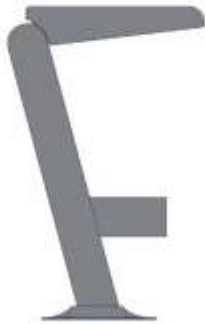

Open End



Open Armless



Cane



HPL Roma (Polypropylene)



LIGHTING

DFC is pleased to provide several options for aisle lighting. Talk to us about your lighting needs or requirements and we will match a great option for your project. Listed Class II 12V DC power supply provided with all orders.



Tivolini Beacon

Yellow, White, and Warm White
 Replaceable AC/DC LED board inside polycarbonate dome
 50,000 hrs (White and Warm White) / 100,000 hrs (Yellow)
 Ideal for row ends with plastic armrests
 Specifications available upon request



Tivoli Versiline

Yellow, White, and Warm White
 LEDs set in polycarbonate clear tube
 40,000 hrs (White and Warm White) / 100,000 hrs (Yellow)
 Typically used with row ends with wood armrests
 Specifications available upon request



Tivoline Mode

Yellow and Warm White
 LEDs set in polycarbonate shroud
 75,000 hrs life expectancy
 Great for all applications
 Specifications available upon request

OPTIONS

DFC aims to provide a complete comfortable experience. Often time this can include conveniences not found in a typical seat setting. Available options below can take your space from typical to tremendous.



Anti-Tip Movable Bases



Card, Pencil & Communion cup



Era Restoration



Custom Engraving Capabilities



Under-seat book racks



Custom Embroidery Available



Lumiere Chair

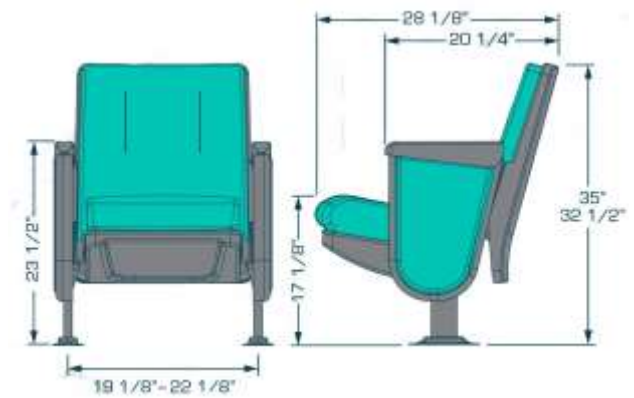
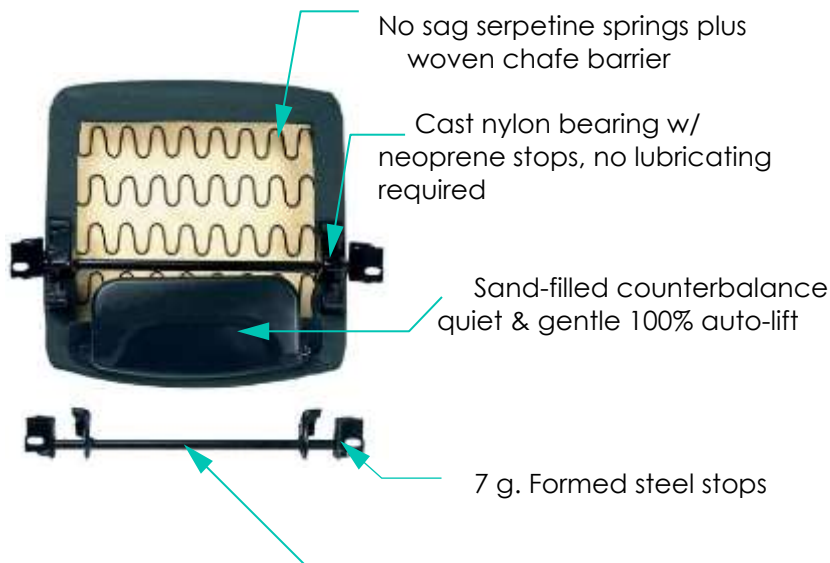
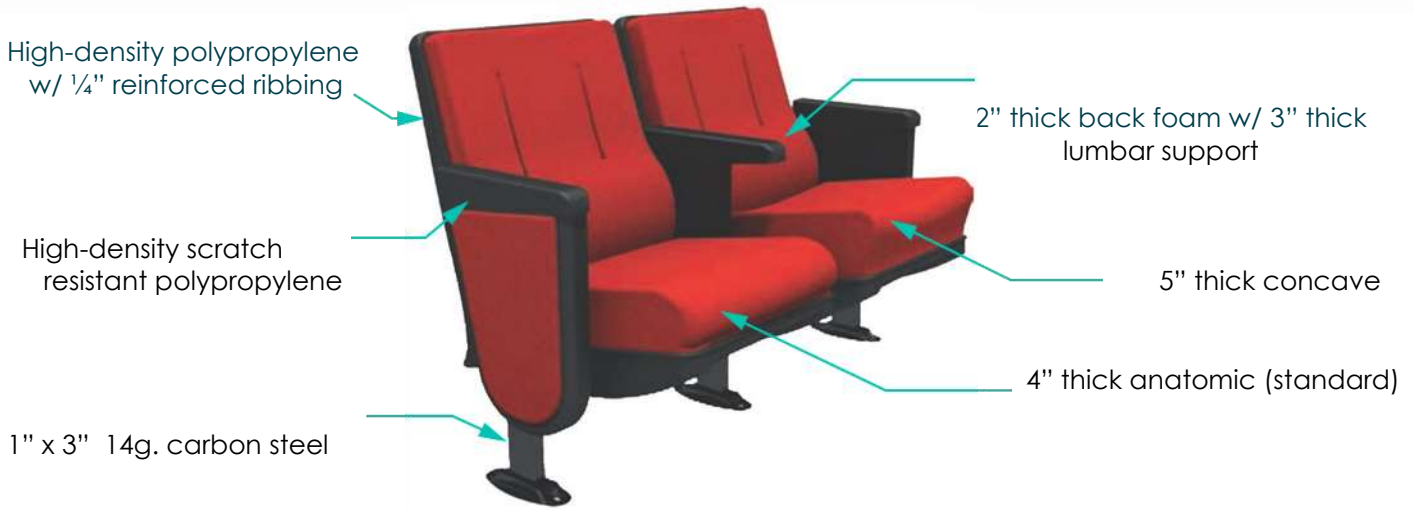

Solid 5/8" steel cross shaft

ARMS OPTIONS



Polypropylene armrest with frontmounted cup holder. Adds an approximate 4" to depth of chair.

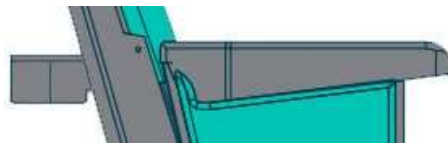

Rear-mounted cup holder



Flat



Scrolled



Longitudinal

Solid wood armrests. Choice of wood and stain. Length within typical depth of chair.

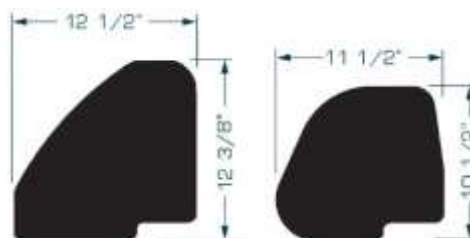



BACK OPTIONS

Each of our backs use 50/55 kg/m³ foam affixed to an injection molded, high-density polypropylene inner back with ¼" reinforced ribbing. Polypropylene is textured to resist scratching and scuffing. Additional outer back options include laminate or wood veneer.



Flat

2" thick foam



Lumbar

2" thick
Foam
increasing
to 3" at
lumbar
area



Vertical Pleats

2" thick foam
increasing to
3" at lumbar area
with decorative
vertical pleating

Button pleating also
available



Opera

2" thick foam
with soft
curved top
of back.

ROW ENDS

Create a unique space by adding custom row ends to your installation. PLAM to cast aluminum to polypropylene, row ends can significantly change the entire feel of the room. Below are common ends provided by DFC. Looking for something you don't see, let us know and...!



3/4" Soft rectangle



3/4" Tapered Radius



3/4" Tapered



3/4" Radius



Full-Length Panel

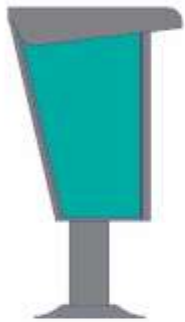

Convention T

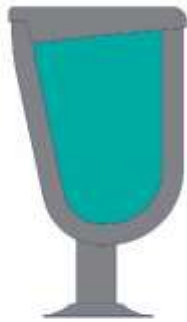

Oval 300



Compact

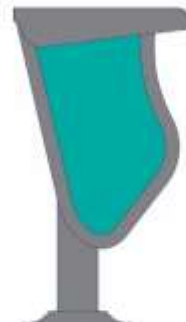

Roma S



HRL (Polypropylene)



Lifting Arm/Cantiliver

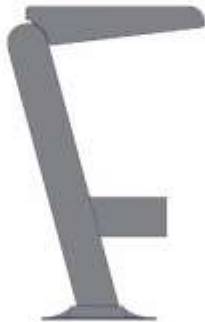

Open End



Open Armless



Cane



HPL Roma (Polypropylene)



LIGHTING

DFC is pleased to provide several options for aisle lighting. Talk to us about your lighting needs or requirements and we will match a great option for your project. Listed Class II 12V DC power supply provided with all orders.



Tivolini Beacon

Yellow, White, and Warm White
 Replaceable AC/DC LED board inside polycarbonate dome
 50,000 hrs (White and Warm White) / 100,000 hrs (Yellow)
 Ideal for row ends with plastic armrests
 Specifications available upon request



Tivoli Versiline

Yellow, White, and Warm White
 LEDs set in polycarbonate clear tube
 40,000 hrs (White and Warm White) / 100,000 hrs (Yellow)
 Typically used with row ends with wood armrests
 Specifications available upon request



Tivoline Mode

Yellow and Warm White
 LEDs set in polycarbonate shroud
 75,000 hrs life expectancy
 Great for all applications
 Specifications available upon request

OPTIONS

DFC aims to provide a complete comfortable experience. Often time this can include conveniences not found in a typical seat setting. Available options below can take your space from typical to tremendous.



Anti-Tip Movable Bases



Card, Pencil & Communion cup



Era Restoration



Custom Engraving Capabilities



Under-seat book racks



Custom Embroidery Available



Convention Love Seat

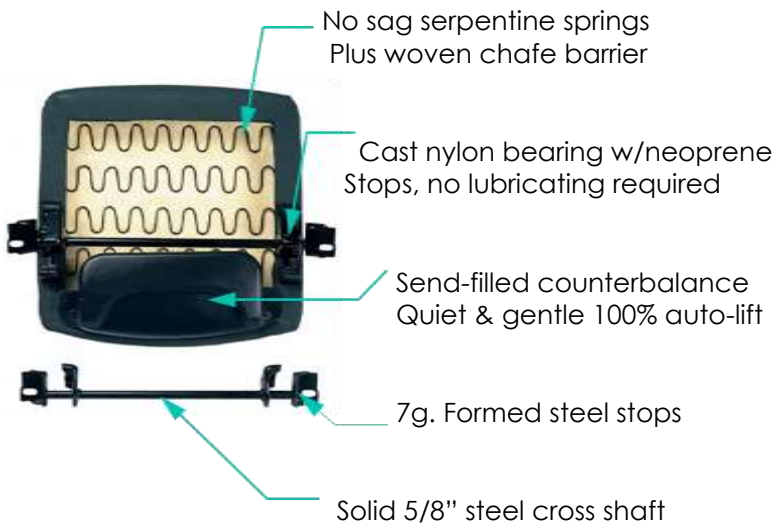

ARMS OPTIONS



Polypropylene armrest with frontmolded cup holder. Adds an approximate 4" to depth of chair.

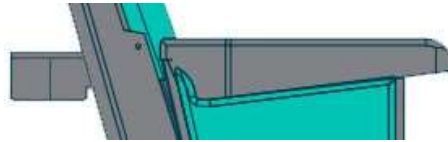

Rear-mounted cup holder



Flat



Scrolled



Longitudinal

Solid wood armrests. Choice of wood and stain. Length within typical depth of chair.

BACK OPTIONS

Each of our backs use 50/55 kg/m³ foam affixed to an injection molded, high-density polypropylene inner back with 1/4" reinforced ribbing. Polypropylene is textured to resist scratching and scuffing. Additional outer back options include laminate or wood veneer.



Flat

2" thick foam



Lumbar

2" thick
Foam
increasing
to 3" at
lumbar
area



Vertical Pleats

2" thick foam
increasing to
3" at lumbar area
with decorative
vertical pleating

Button pleating also
available



Opera

2" thick foam
with soft
curve at top
of back.

ROW ENDS

Create a unique space by adding custom row ends to your installation. PLAM to cast aluminum to polypropylene, row ends can significantly change the entire feel of the room. Below are common ends provided by DFC. Looking for something you don't see, let us know and...!



3/4" Soft rectangle



3/4" Tapered Radius



3/4" Tapered



3/4" Radius



Full-Length Panel

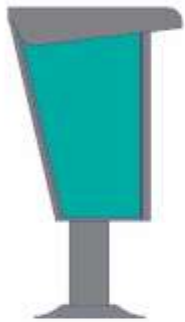

Convention T

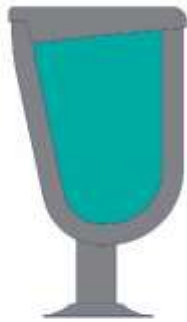

Oval 300



Compact

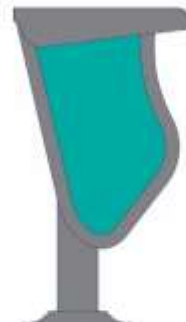

Roma S



HRL (Polypropylene)



Lifting Arm/Cantiliver

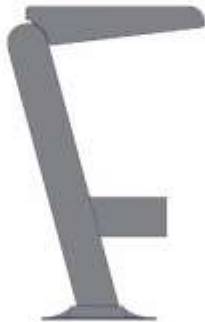

Open End



Open Armless



Cane



HPL Roma (Polypropylene)



LIGHTING

DFC is pleased to provide several options for aisle lighting. Talk to us about your lighting needs or requirements and we will match a great option for your project. Listed Class II 12V DC power supply provided with all orders.



Tivolini Beacon

Yellow, White, and Warm White
 Replaceable AC/DC LED board inside polycarbonate dome
 50,000 hrs (White and Warm White) / 100,000 hrs (Yellow)
 Ideal for row ends with plastic armrests
 Specifications available upon request



Tivoli Versiline

Yellow, White, and Warm White
 LEDs set in polycarbonate clear tube
 40,000 hrs (White and Warm White) / 100,000 hrs (Yellow)
 Typically used with row ends with wood armrests
 Specifications available upon request



Tivoline Mode

Yellow and Warm White
 LEDs set in polycarbonate shroud
 75,000 hrs life expectancy
 Great for all applications
 Specifications available upon request

OPTIONS

DFC aims to provide a complete comfortable experience. Often time this can include conveniences not found in a typical seat setting. Available options below can take your space from typical to tremendous.



Anti-Tip Movable Bases



Card, Pencil & Communion cup



Era Restoration



Custom Engraving Capabilities



Under-seat book racks



Custom Embroidery Available



Compact Convention Chair

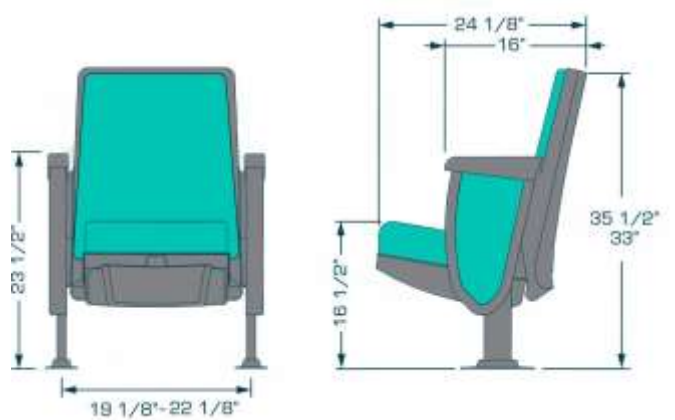
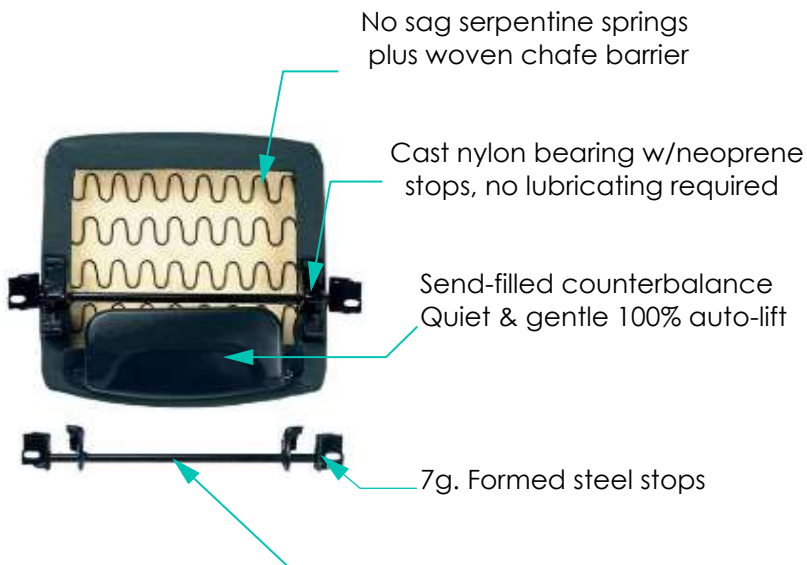

Solid 5/8" steel cross shaft

ARMS OPTIONS



Polypropylene armrest with frontmounted cup holder. Adds an approximate 4" to depth of chair.

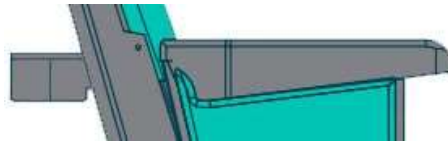

Rear-mounted cup holder



Flat



Scrolled



Longitudinal

Solid wood armrests. Choice of wood and stain. Length within typical depth of chair.

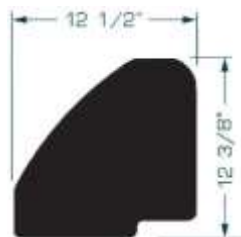

Royal

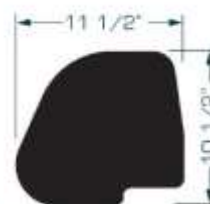

Tec

BACK OPTIONS

Each of our backs use 50/55 kg/m³ foam affixed to an injection molded, high-density polypropylene inner back with 1/4" reinforced ribbing. Polypropylene is textured to resist scratching and scuffing. Additional outer back options include laminate or wood veneer.



Flat

2" thick foam



Lumbar

2" thick
Foam
increasing
to 3" at
lumbar
area



Vertical Pleats

2" thick foam
increasing to
3" at lumbar area
with decorative
vertical pleating

Button pleating also
available



Opera

2" thick foam
with soft
curve at top
of back.

ROW ENDS

Create a unique space by adding custom row ends to your installation. PLAM to cast aluminum to polypropylene, row ends can significantly change the entire feel of the room. Below are common ends provided by DFC. Looking for something you don't see, let us know and...!



3/4" Soft rectangle



3/4" Tapered Radius



3/4" Tapered



3/4" Radius



Full-Length Panel

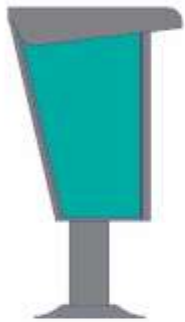

Convention T

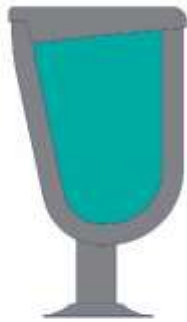

Oval 300



Compact

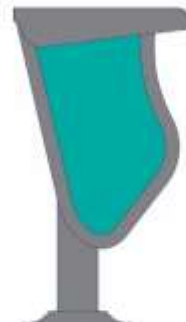

Roma S



HRL (Polypropylene)



Lifting Arm/Cantiliver

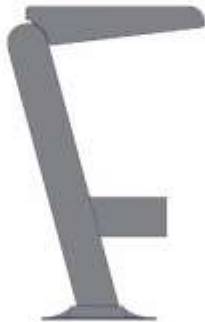

Open End



Open Armless



Cane



HPL Roma (Polypropylene)



LIGHTING

DFC is pleased to provide several options for aisle lighting. Talk to us about your lighting needs or requirements and we will match a great option for your project. Listed Class II 12V DC power supply provided with all orders.



Tivolini Beacon

Yellow, White, and Warm White
 Replaceable AC/DC LED board inside polycarbonate dome
 50,000 hrs (White and Warm White) / 100,000 hrs (Yellow)
 Ideal for row ends with plastic armrests
 Specifications available upon request



Tivoli Versiline

Yellow, White, and Warm White
 LEDs set in polycarbonate clear tube
 40,000 hrs (White and Warm White) / 100,000 hrs (Yellow)
 Typically used with row ends with wood armrests
 Specifications available upon request



Tivoline Mode

Yellow and Warm White
 LEDs set in polycarbonate shroud
 75,000 hrs life expectancy
 Great for all applications
 Specifications available upon request

OPTIONS

DFC aims to provide a complete comfortable experience. Often time this can include conveniences not found in a typical seat setting. Available options below can take your space from typical to tremendous.



Anti-Tip Movable Bases



Card, Pencil & Communion cup



Era Restoration



Custom Engraving Capabilities



Under-seat book racks



Custom Embroidery Available

Convention Chair



High-density polypropylene w/ 1/4" reinforced ribbing

High-density scratch resistant polypropylene

1" x 3" 14g. carbon steel

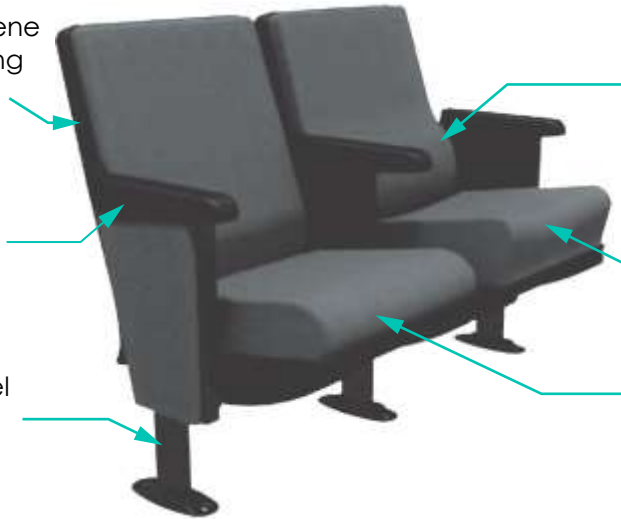

2" thick back foam w/ 3" thick lumbar support

5" thick concave

4" thick anatomic (standard)

No sag serpentine springs plus woven chafe barrier

Cast nylon bearing w/neoprene stops, no lubricating required

Send-filled counterbalance quiet & gentle 100% auto-lift

7g. Formed steel stops

Solid 5/8" steel cross shaft

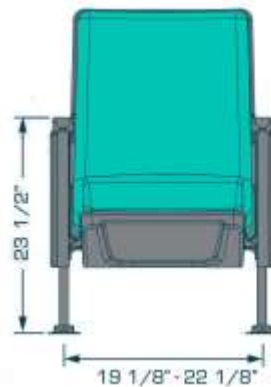
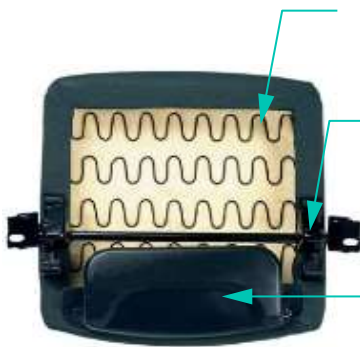

ARMS OPTIONS



Polypropylene armrest with frontmounted cup holder. Adds an approximate 4" to depth of chair.

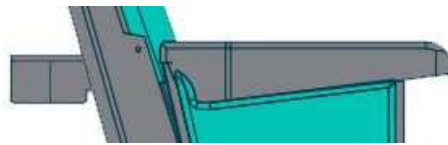

Rear-mounted cup holder



Flat



Scrolled



Longitudinal

Solid wood armrests. Choice of wood and stain. Length within typical depth of chair.

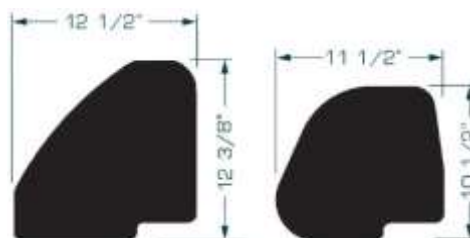

BACK OPTIONS

Each of our backs use 50/55 kg/m³ foam affixed to an injection molded, high-density polypropylene inner back with ¼" reinforced ribbing. Polypropylene is textured to resist scratching and scuffing. Additional outer back options include laminate or wood veneer.



Flat

2" thick foam



Lumbar

2" thick
Foam
increasing
to 3" at
lumbar
area



Vertical Pleats

2" thick foam
increasing to
3" at lumbar area
with decorative
vertical pleating

Button pleating also
available



Opera

2" thick foam
with soft
curved top
of back.

ROW ENDS

Create a unique space by adding custom row ends to your installation. PLAM to cast aluminum to polypropylene, row ends can significantly change the entire feel of the room. Below are common ends provided by DFC. Looking for something you don't see, let us know and...!



3/4" Soft rectangle



3/4" Tapered Radius



3/4" Tapered



3/4" Radius



Full-Length Panel

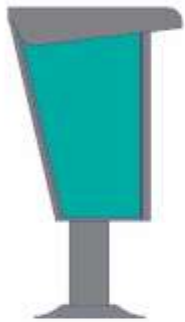

Convention T

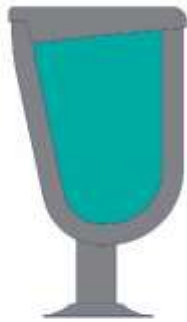

Oval 300



Compact

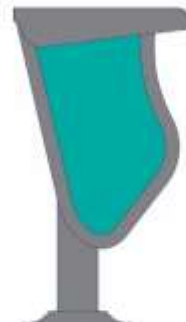

Roma S



HRL (Polypropylene)



Lifting Arm/Cantiliver

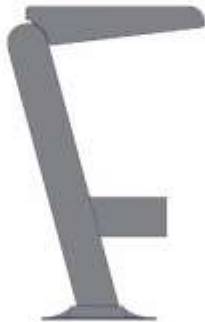

Open End



Open Armless



Cane



HPL Roma (Polypropylene)



LIGHTING

DFC is pleased to provide several options for aisle lighting. Talk to us about your lighting needs or requirements and we will match a great option for your project. Listed Class II 12V DC power supply provided with all orders.



Tivolini Beacon

Yellow, White, and Warm White
 Replaceable AC/DC LED board inside polycarbonate dome
 50,000 hrs (White and Warm White) / 100,000 hrs (Yellow)
 Ideal for row ends with plastic armrests
 Specifications available upon request



Tivoli Versiline

Yellow, White, and Warm White
 LEDs set in polycarbonate clear tube
 40,000 hrs (White and Warm White) / 100,000 hrs (Yellow)
 Typically used with row ends with wood armrests
 Specifications available upon request



Tivoline Mode

Yellow and Warm White
 LEDs set in polycarbonate shroud
 75,000 hrs life expectancy
 Great for all applications
 Specifications available upon request

OPTIONS

DFC aims to provide a complete comfortable experience. Often time this can include conveniences not found in a typical seat setting. Available options below can take your space from typical to tremendous.



Anti-Tip Movable Bases



Card, Pencil & Communion cup



Era Restoration



Custom Engraving Capabilities



Under-seat book racks



Custom Embroidery Available



Audi Roma Chair

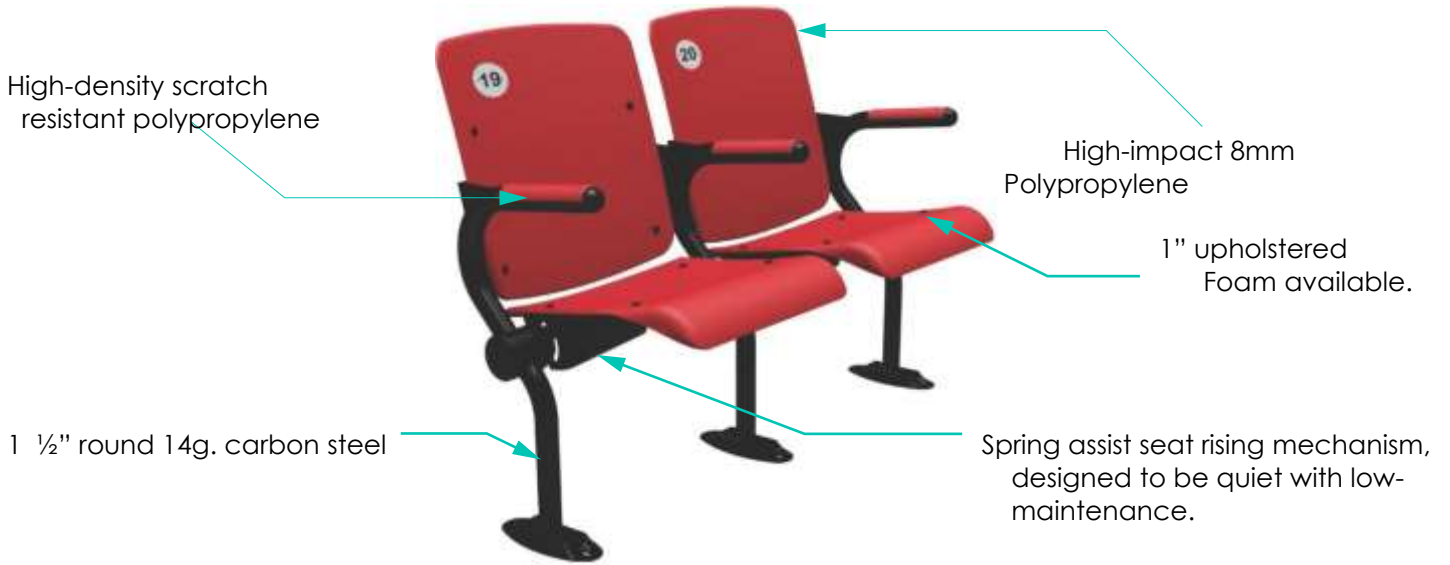

ARMS OPTIONS



Polypropylene armrest with frontmounted cup holder. Adds an approximate 4" to depth of chair.

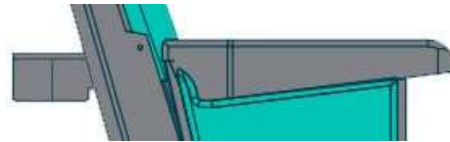

Rear-mounted cup holder

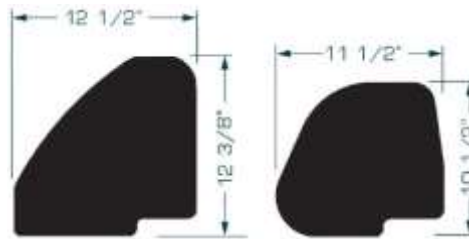

LIGHTING

DFC is pleased to provide several options for aisle lighting. Talk to us about your lighting needs or requirements and we will match a great option for your project. Listed Class II 12V DC power supply provided with all orders.



Tivolini Beacon

Yellow, White, and Warm White
 Replaceable AC/DC LED board inside polycarbonate dome
 50,000 hrs (White and Warm White) / 100,000 hrs (Yellow)
 Ideal for row ends with plastic armrests
 Specifications available upon request

OPTIONS

DFC aims to provide a complete comfortable experience. Often time this can include conveniences not found in a typical seat setting. Available options below can take your space from typical to tremendous.



Anti-Tip Movable Bases



Card, Pencil & Communion cup



Under-seat book racks



Custom Embroidery Available

Alessandria Rocker Chair



High-density polypropylene outer back over 18g. square tube iron frame.

High-density scratch resistant polypropylene

1" x 3" 14g. carbon steel

3" back foam w/4" thick lumbar support.

5" thick concave

4" thick anatomic

Patented rocker mechanism



No sag serpentine springs plus woven chafe barrier

Cast nylon bearing w/neoprene stops, no lubricating required

Send-filled counterbalance quiet & gentle 100% auto-lift

7g. Formed steel stops

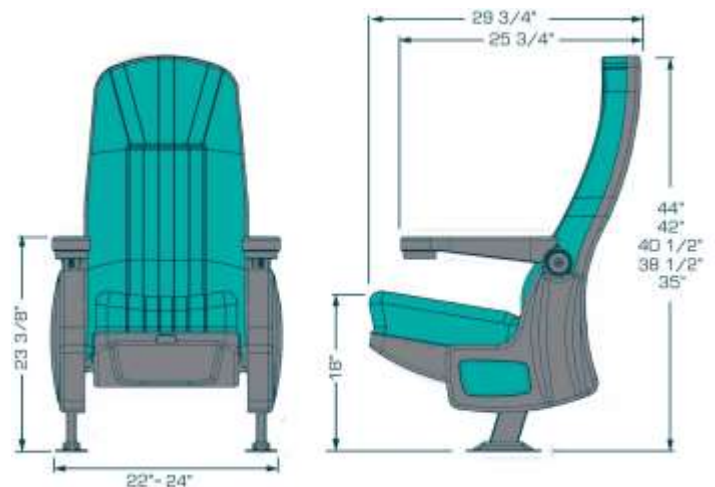

Solid 5/8" steel cross shaft

ARMS OPTIONS



Polypropylene armrest with frontmounted cup holder. Adds an approximate 4" to depth of chair.

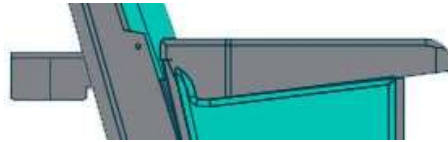

Rear-mounted cup holder



Flat



Scrolled



Longitudinal

Solid wood armrests. Choice of wood and stain. Length within typical depth of chair.

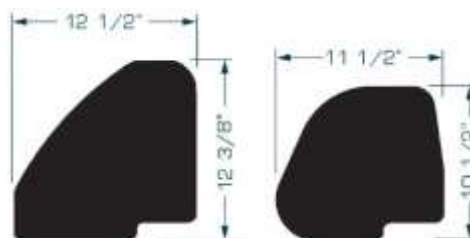

LIGHTING

DFC is pleased to provide several options for aisle lighting. Talk to us about your lighting needs or requirements and we will match a great option for your project. Listed Class II 12V DC power supply provided with all orders.



Tivolini Beacon

Yellow, White, and Warm White
 Replaceable AC/DC LED board inside polycarbonate dome
 50,000 hrs (White and Warm White) / 100,000 hrs (Yellow)
 Ideal for row ends with plastic armrests
 Specifications available upon request



Tivoli Versiline

Yellow, White, and Warm White
 LEDs set in polycarbonate clear tube
 40,000 hrs (White and Warm White) / 100,000 hrs (Yellow)
 Typically used with row ends with wood armrests
 Specifications available upon request



Tivoline Mode

Yellow and Warm White
 LEDs set in polycarbonate shroud
 75,000 hrs life expectancy
 Great for all applications
 Specifications available upon request.

OPTIONS

DFC aims to provide a complete comfortable experience. Often time this can include conveniences not found in a typical seat setting. Available options below can take your space from typical to tremendous.



Anti-Tip Movable Bases



Card, Pencil & Communion cup



Custom Engraving Capabilities



Under-seat book racks



Custom Embroidery Available



Alessandria Fixed Chair

High-density polypropylene outer back over 18g. square tube iron frame.

High-density scratch resistant polypropylene

1" x 3" 14g. carbon steel



3" back foam w/4" thick lumbar support.

5" thick concave

4" thick anatomic

No sag serpentine springs plus woven chafe barrier

Cast nylon bearing w/neoprene stops, no lubricating required

Send-filled counterbalance quiet & gentle 100% auto-lift

7g. Formed steel stops



Solid 5/8" steel cross shaft

ARMS OPTIONS



Polypropylene armrest with frontmounted cup holder. Adds an approximate 4" to depth of chair.

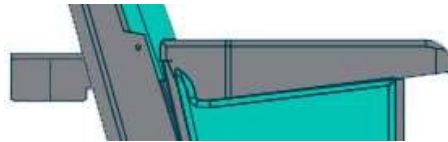

Rear-mounted cup holder



Flat



Scrolled



Longitudinal

Solid wood armrests. Choice of wood and stain. Length within typical depth of chair.

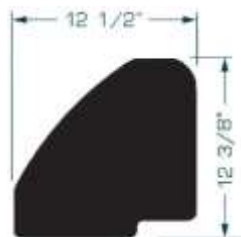

Royal



Tec

LIGHTING

DFC is pleased to provide several options for aisle lighting. Talk to us about your lighting needs or requirements and we will match a great option for your project. Listed Class II 12V DC power supply provided with all orders.



Tivolini Beacon

Yellow, White, and Warm White
 Replaceable AC/DC LED board inside polycarbonate dome
 50,000 hrs (White and Warm White) / 100,000 hrs (Yellow)
 Ideal for row ends with plastic armrests
 Specifications available upon request



Tivoli Versiline

Yellow, White, and Warm White
 LEDs set in polycarbonate clear tube
 40,000 hrs (White and Warm White) / 100,000 hrs (Yellow)
 Typically used with row ends with wood armrests
 Specifications available upon request



Tivoline Mode

Yellow and Warm White
 LEDs set in polycarbonate shroud
 75,000 hrs life expectancy
 Great for all applications
 Specifications available upon request.

OPTIONS

DFC aims to provide a complete comfortable experience. Often time this can include conveniences not found in a typical seat setting. Available options below can take your space from typical to tremendous.



Anti-Tip Movable Bases



Card, Pencil & Communion cup



Custom Engraving Capabilities



Under-seat book racks



Custom Embroidery Available



Alessandria Convention Chair

High-density polypropylene outer back over 18g. square tube iron frame.

High-density scratch resistant polypropylene

1" x 3" 14g. carbon steel

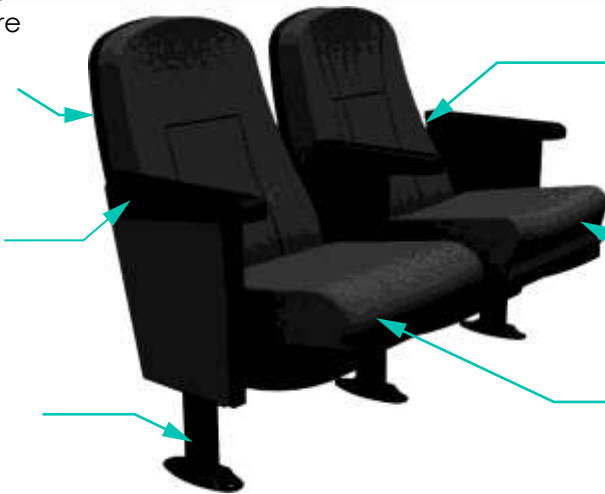

3" back foam w/4" thick lumbar support.

5" thick concave

4" thick anatomic

No sag serpentine springs plus woven chafe barrier

Cast nylon bearing w/neoprene stops, no lubricating required

Sand-filled counterbalance quiet & gentle 100% auto-lift

7g. Formed steel stops

Solid 5/8" steel cross shaft

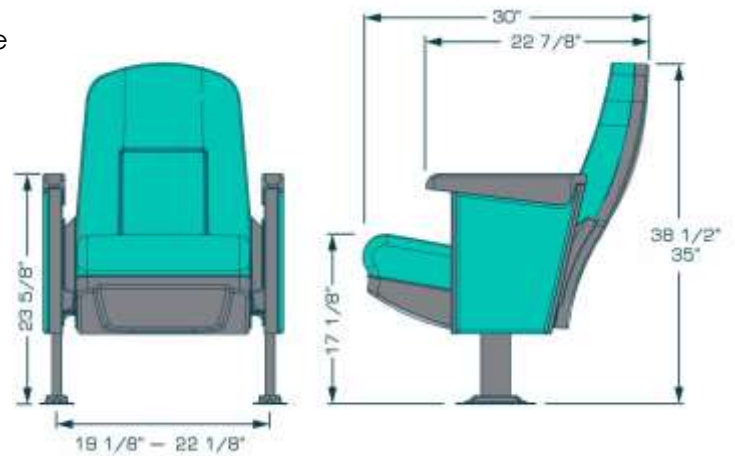
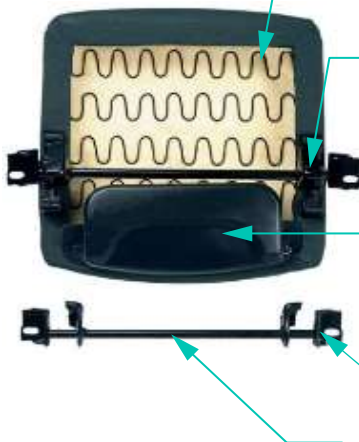

ARMS OPTIONS



Polypropylene armrest with frontmounted cup holder. Adds an approximate 4" to depth of chair.

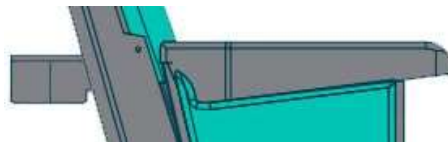

Rear-mounted cup holder



Flat



Scrolled



Longitudinal

Solid wood armrests. Choice of wood and stain. Length within typical depth of chair.

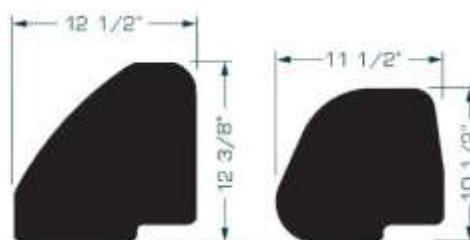

LIGHTING

DFC is pleased to provide several options for aisle lighting. Talk to us about your lighting needs or requirements and we will match a great option for your project. Listed Class II 12V DC power supply provided with all orders.



Tivolini Beacon

Yellow, White, and Warm White
 Replaceable AC/DC LED board inside polycarbonate dome
 50,000 hrs (White and Warm White) / 100,000 hrs (Yellow)
 Ideal for row ends with plastic armrests
 Specifications available upon request



Tivoli Versiline

Yellow, White, and Warm White
 LEDs set in polycarbonate clear tube
 40,000 hrs (White and Warm White) / 100,000 hrs (Yellow)
 Typically used with row ends with wood armrests
 Specifications available upon request



Tivoline Mode

Yellow and Warm White
 LEDs set in polycarbonate shroud
 75,000 hrs life expectancy
 Great for all applications
 Specifications available upon request.

OPTIONS

DFC aims to provide a complete comfortable experience. Often time this can include conveniences not found in a typical seat setting. Available options below can take your space from typical to tremendous.



Anti-Tip Movable Bases



Card, Pencil & Communion cup



Era Restoration



Custom Engraving Capabilities



Under-seat book racks



Custom Embroidery Available

INSTALLATIONS







